

MEDICAL / OFFICE FOR LEASE

BROADWAY MEDICAL CENTER

8089 S. LINCOLN STREET, LITTLETON, CO 80122



TREVEY
COMMERCIAL
REAL ESTATE

RATE REDUCED!



PROPERTY FEATURES

- 900 SF; 1,020 SF & 1,312 SF Available Immediately on Second Floor - **Combine for 3,232 SF Max Contiguous**
- Move-in Ready Suites Accessible via Elevator
- 24-hour Building Access
- Monument Signage Available
- Recently Renovated Lobby, Restrooms & Parking Lot
- Prime Location with High Visibility Along South Broadway
- Ideally Located Near Littleton Adventist Hospital & UC Health Highlands Ranch Hospital
- Easy Access to C-470, South Broadway, County Line Rd. & Santa Fe Dr.
- Conveniently Located Near Restaurants, Retail & Hotels

PROPERTY DETAILS

Second Floor

AVAILABLE SUITES

- **Suite 206:** 900 SF
- **Suite 207:** 1,020 SF
- **Suite 202:** 1,312 SF
- **Max Contig.:** 3,232 SF

LEASE RATE \$25.00 / SF MG

LEASE TYPE Modified Gross

TENANT IMPROVEMENTS T.I. Package Negotiable

PARKING 3.86:1,000 (97 Surface)

BUILDING SIZE 25,802 SF

Y.O.C. 1984 - Recently Renovated

ZONING MU (Mixed-Use)

CITY / COUNTY Littleton / Arapahoe

DEMOGRAPHICS

Radius	Population	Avg. HH Income	Home Value
2 Mile	48,217	\$130,461	\$447,928
5 Mile	251,321	\$140,998	\$495,566
10 Mile	825,435	\$122,982	\$480,821

TRAFFIC COUNTS

Vehicles Per Day (VPD)

Approx. 17,600 VPD on Lincoln St. at Mineral Ave.

Approx. 37,000 VPD on S. Broadway at Grant Way

Approx. 83,000 VPD along C-470 at Santa Fe.

TREVEY COMMERCIAL

10510 Dransfeldt Rd, Suite 100
Parker, Colorado 80134
303-841-1400 | www.trevey.com

DAVID MARULLI

Capital Markets
david@trevey.com
C: 720-298-2840

NICK BEACH

V.P. Sales & Leasing
nbeach@trevey.com
C: 719-237-0880



AVAILABLE SUITES

3,232 SF TOTAL AVAILABLE

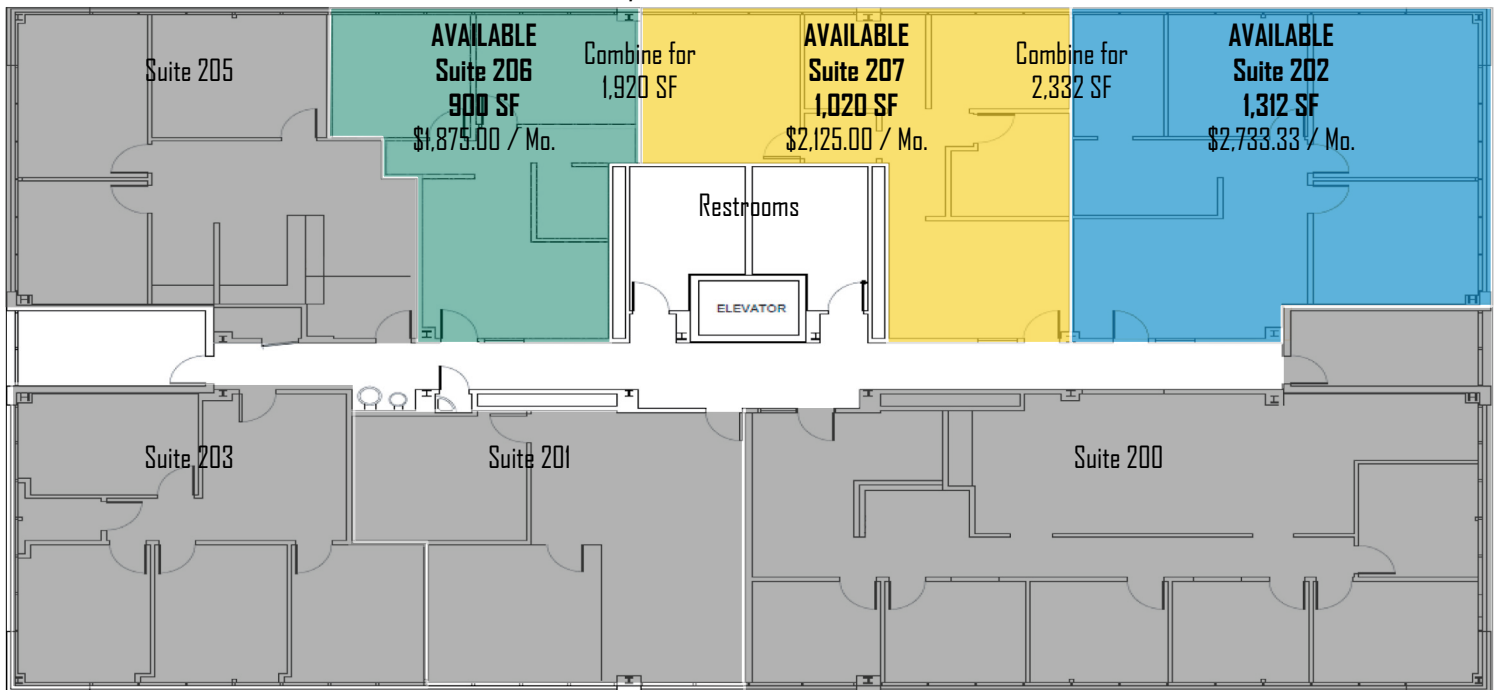

TREVEY COMMERCIAL
 10510 Dransfeldt Rd, Suite 100
 Parker, Colorado 80134
 303-841-1400 | www.trevey.com

DAVID MARULLI
 Capital Markets
david@trevey.com
 C: 720-298-2840

NICK BEACH
 V.P. Sales & Leasing
nbeach@trevey.com
 C: 719-237-0880

[CLICK HERE TO DOWNLOAD CREC BROKERAGE DISCLOSURE](#)

Information contained herein, while not guaranteed, is from sources believed reliable. Price, terms and information subject to change. Please call to confirm current property status and accuracy of information contained herein.