

COMMERCIAL BUILDING FOR SALE / LEASE

LA-Z-BOY RETAIL

12810 STROH RANCH CT., PARKER, CO 80134



OWNER-USER OPPORTUNITY!



PROPERTY FEATURES

- Wide Span Owner / User Retail Building for Sale or Lease
- Currently Leased by La-Z-Boy Incorporated thru July 2025
- **Do Not Disturb Tenant / Showings by Appointment Only**
- 20,375 SF Free Standing Building with 16,400 SF Showroom
- 8' x 10' Roll-up Door with Loading Dock
- 15' Clear Height in Warehouse Area
- EPDM Rubber Roof Replaced in 2022 with 20-year Warranty
- Freshly Sealed and Striped Parking Lot
- Fully Sprinkled Building
- Owner / Tenant Advertising on Monument Sign Available
- Adjacent to King Soopers Shopping Center and Walgreen's
- Located in High Demographic, Fast Growing South Parker Market
- ±300' of Frontage on Parker Rd. / SH 83

PROPERTY DETAILS

AVAILABLE	±20,375 SF on ±1.56 AC
PRICE	\$5,950,000 (\$292/ SF)
TAXES	\$85,707 (2024 Est.)
LOADING	One (1) 8' x 10' Dock Door
PARKING	2.45:1000 (48 Spaces)
ZONING	Commercial
POWER	600 AMP / 3-Phase
Y.O.C.	2004
WATER / SANITATION	PWSD (Parker Water & Sanitation District)
CITY / COUNTY	Parker / Douglas

TREVEY COMMERCIAL
10510 Dransfeldt Rd, Suite 100
Parker, Colorado 80134
303-841-1400 | www.trevey.com

MITCH TREVEY
Managing Director
mitch@trevey.com
C: 303-619-7192

DAVID MARULLI
Capital Markets
david@trevey.com
C: 720-298-2840

TOMMY DAHER
Associate Broker
tommy@trevey.com
C: 303-916-8231

LA-Z-BOY RETAIL

12810 STROH RANCH CT., PARKER, CO 80134

BUILDING LAYOUT

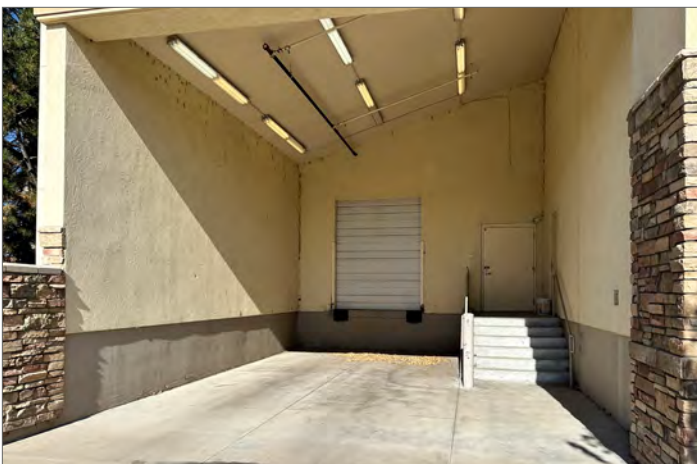
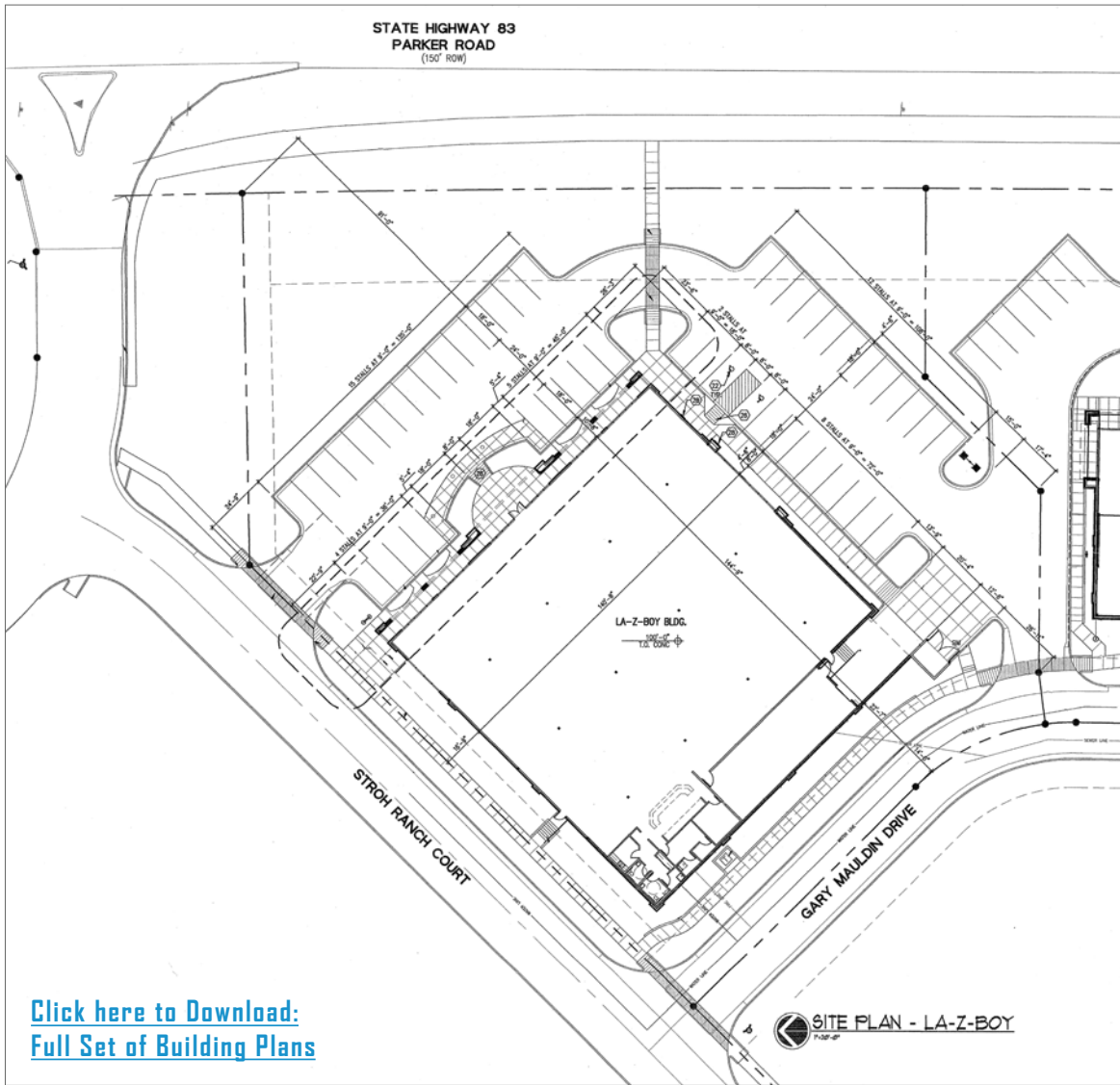

Loading Dock



Monument Sign

SURROUNDING AREA



Facing South



Facing North

SITE AERIAL



DEMOGRAPHICS

Radius	Population	Income	Home Value
2 Mile	22,629	\$160,673	\$620,543
5 Mile	115,787	\$159,341	\$651,881
10 Mile	432,552	\$153,902	\$647,586

*2028 Projected Population

PARKER MARKET SERVICE AREA

- Parker, CO consists of two zip codes (80134 & 80138) delivering ±107,434 Residents.
- 80134 is the 2nd Most Populous Zip Code in the State of Colorado out of 513 Zip Codes.

TRAFFIC COUNTS

Vehicles Per Day (VPD)
Approx. 11,000 VPD at J Morgan Blvd. & Parker Rd.
Approx. 40,500 VPD at Stroh Rd. & Parker Rd.
Approx. 69,000 VPD on Parker Rd.



MITCH TREVEY
 Managing Director
 mitch@trevey.com
 C: 303-619-7192

DAVID MARULLI
 Capital Markets
 david@trevey.com
 C: 720-298-2840

TOMMY DAHER
 Associate Broker
 tommy@trevey.com
 C: 303-916-8231

[CLICK HERE TO DOWNLOAD CREC BROKERAGE DISCLOSURE](#)

Information contained herein, while not guaranteed, is from sources believed reliable. Price, terms and information subject to change. Please call to confirm current property status and accuracy of information contained herein.